

# DNH10 FUSE SWITCH DISCONNECTOR

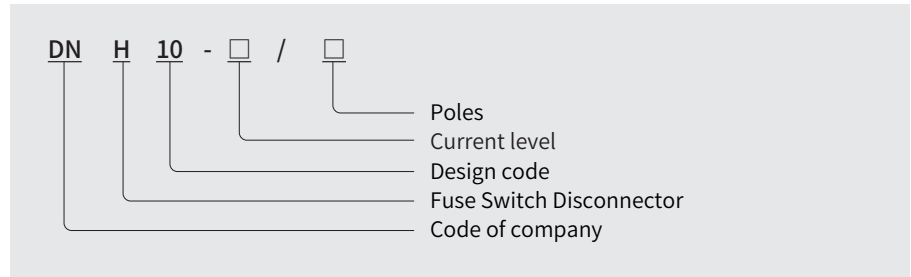

## Model & Meaning



## Technical Parameter

Specifications		DNH10-100	DNH10-250
Rated working voltage Ue	V	690	AC400/690/DC440
Rated working current Ie	A	160	250
Rated insulation voltage Ui	A	AC800	1000
Rated heating current Ith	V	160	250
Rated impulse withstand voltage Uimp	kV	8	12
Rated limiting short-circuit current AC 400V	kA	120	120
Rated frequency	Hz	40~60	50~60
Connection section	mm <sup>2</sup>	15~50	
Usage category (with fused )		AC-23B(AV400) AC-21B(AV690)	AC-23B(AC400V) AC-21B(AC690V) DC-21B(DC440V)
Electrical lifespan	times	200	200
Mechanical lifespan	times	2000	2000
Working conditions	Air temperature	-5°C ~+ 40°C	
	Altitude	≤ 2000m	
	Installation category and pollution level	No explosive hazardous media, no rain or snow invasion environment	
Note: If expected to be used under conditions where the ambient air temperature is above+40 °C or below -5 °C, the user should explain to the manufacturer.			

## Dimensions (mm)

DNH10-100

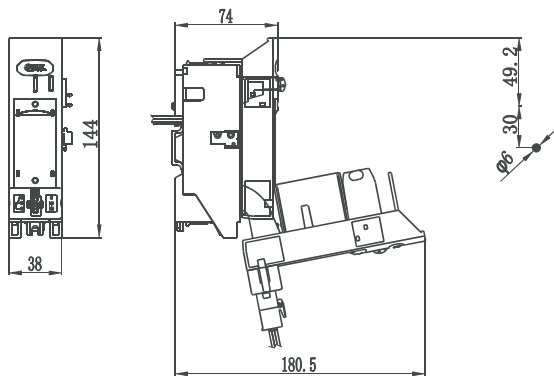

DNH10-250

